

# CASSELDEN PLACE

TENANCIES

LEVEL 15

CHANGEOVER FLOOR

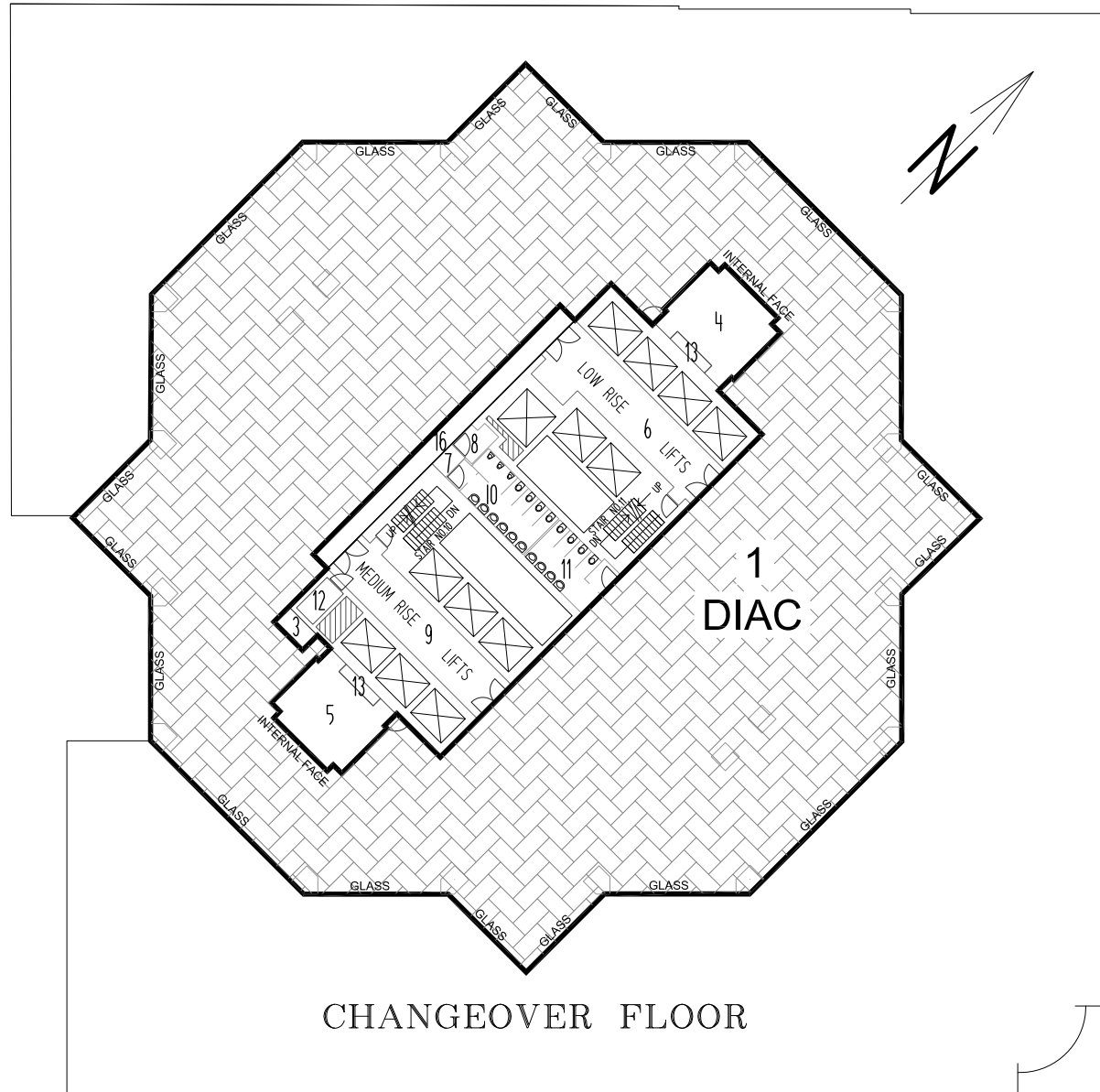

LONSDALE

STREET

1 DIAC - NLA 1397.9m<sup>2</sup>

WHOLE FLOOR NLA 1397.9m<sup>2</sup>  
TENANCY NLA 1397.9m<sup>2</sup>

3 DISUSED COMMS CUPBOARD:	3.3m <sup>2</sup>
4 AHU (25.5m <sup>2</sup> inside)	29.1m <sup>2</sup>
5 AHU (24.9m <sup>2</sup> inside)	28.6m <sup>2</sup>
6 LIFT LOBBY:	37.8m <sup>2</sup>
7 PASSAGE:	1.5m <sup>2</sup>
8 TEA ROOM:	3.2m <sup>2</sup>
9 LIFT LOBBY:	34.7m <sup>2</sup>

10 MALE TOILETS:	17.6m <sup>2</sup>
11 FEMALE TOILETS:	14.5m <sup>2</sup>
12 ELEC, TELE ROOM:	3.2m <sup>2</sup>
13 MECH. PIPE RISERS	4.2m <sup>2</sup>
16 CHANGEOVER PASSAGE	27.2m <sup>2</sup>

RISERS	4.5m <sup>2</sup>	STAIR No. 10:	10.9m <sup>2</sup>
SHAFTS	92.6m <sup>2</sup>	STAIR No. 11:	10.9m <sup>2</sup>

**NOTE:**

THE NET LETTABLE AREA IS SHOWN ENCLOSED BY CONTINUOUS THICK LINES.

THE NET LETTABLE AREA IS BASED ON THE PROPERTY COUNCIL OF AUSTRALIA METHOD OF MEASUREMENT FOR LETTABLE AREA (2008 REVISION)

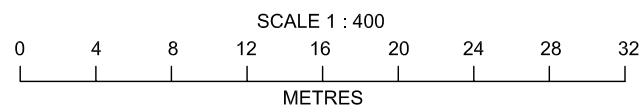

**TENANCY AREA**  
CASSELDEN PLACE  
2 LONSDALE STREET MELBOURNE  
**LEVEL 15**

DATE OF SURVEY	VERSION	PROJECT No.  VW05233
15/11/2010	0	
DRAWN	CHECKED	
MAO	STEPHEN FALZON (LS)	