

# CASSELDEN PLACE

TENANCIES

LEVEL 2

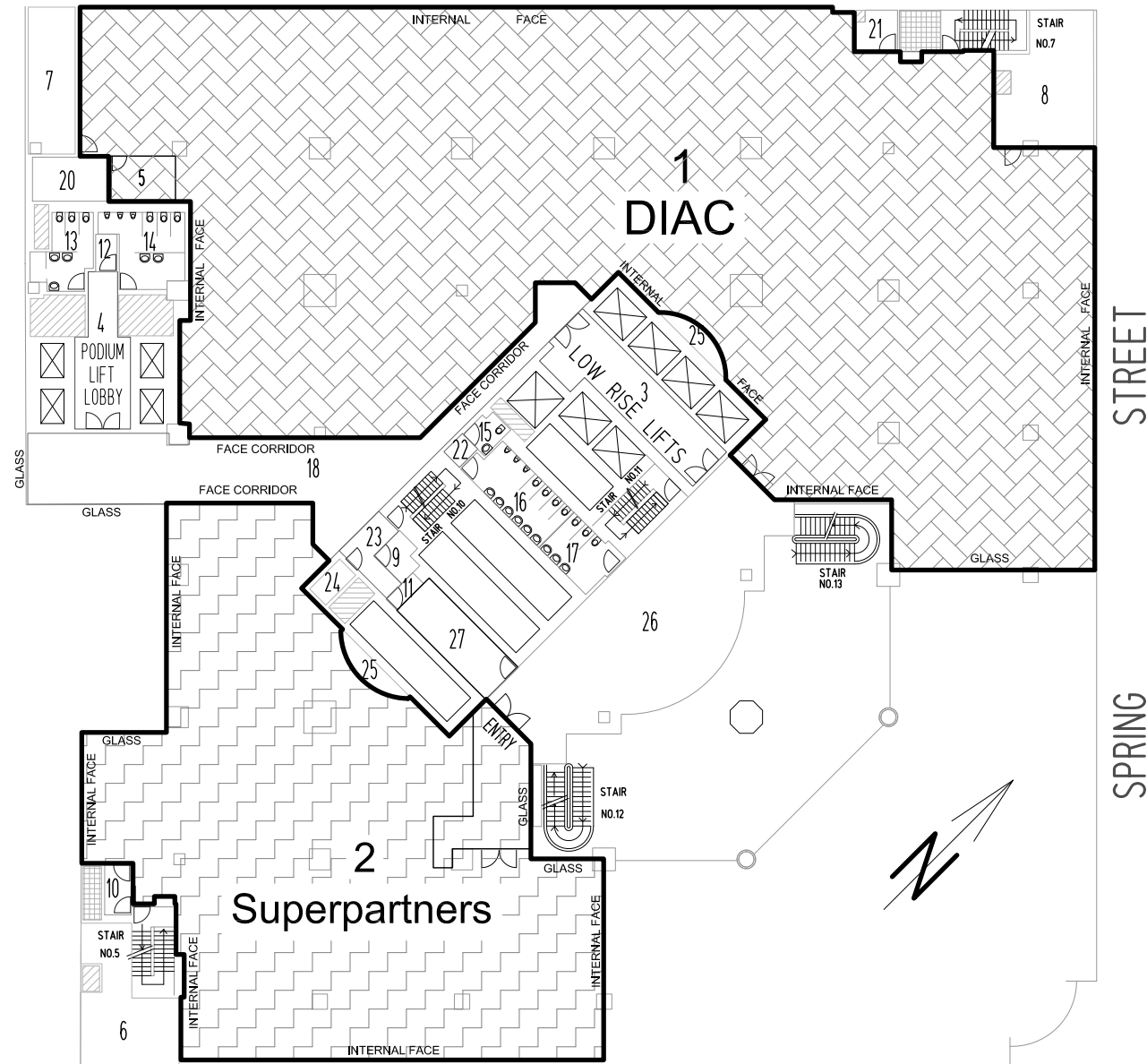

1 DIAC - NLA 1366.8m<sup>2</sup>  
 2 Superpartners - NLA 652.3m<sup>2</sup>  
 (For lease purposes NLA 621.2m<sup>2</sup>)

WHOLE FLOOR NLA 2300.9m<sup>2</sup>  
 TENANCY NLA 2019.1m<sup>2</sup>

3	LIFT LOBBY:	37.3m <sup>2</sup>	16	MALE TOILETS:	18.5m <sup>2</sup>
4	PODIUM LIFT LOBBY:	24.6m <sup>2</sup>	17	FEMALE TOILETS:	11.6m <sup>2</sup>
5	COMMS/COMPUTER	10.0m <sup>2</sup>	18	PASSAGE	120.4m <sup>2</sup>
6	AHU	34.3m <sup>2</sup>	20	PRINT ROOM	11.7m <sup>2</sup>
7	AHU	24.1m <sup>2</sup>	21	TEA ROOM:	5.5m <sup>2</sup>
8	AHU	41.3m <sup>2</sup>	22	PASSAGE:	2.0m <sup>2</sup>
9	TEA ROOM:	4.5m <sup>2</sup>	23	PASSAGE:	7.1m <sup>2</sup>
10	TEA ROOM:	4.7m <sup>2</sup>	24	ELEC, TELE ROOM	3.2m <sup>2</sup>
11	CLEANERS ROOM:	2.0m <sup>2</sup>	25	MECH. PIPE RISERS	9.3m <sup>2</sup>
12	CLEANERS ROOM:	2.8m <sup>2</sup>	26	FOYER	141.3m <sup>2</sup>
13	FEMALE TOILETS:	11.9m <sup>2</sup>	27	STORE:	20.1m <sup>2</sup>
14	MALE TOILETS:	17.6m <sup>2</sup>			
15	UNISEX DISABLED WC:	4.0m <sup>2</sup>			

RISERS SHAFTS EXHAUSTS	27.1m <sup>2</sup> 7.4m <sup>2</sup> 9.3m <sup>2</sup>	STAIR No. 5: 12.6m <sup>2</sup> STAIR No. 10: 10.9m <sup>2</sup> STAIR No. 12: 15.1m <sup>2</sup>	STAIR No. 7: 11.1m <sup>2</sup> STAIR No. 11: 10.9m <sup>2</sup> STAIR No. 13: 15.1m <sup>2</sup>
------------------------------	--	---	---

STREET  
 SPRING

LONSDALE STREET

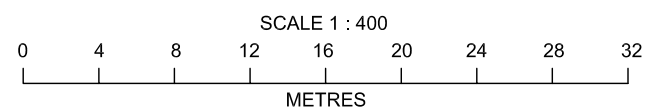

**NOTE:**

THE NET LETTABLE AREA IS SHOWN ENCLOSED BY CONTINUOUS THICK LINES.

THE NET LETTABLE AREA IS BASED ON THE PROPERTY COUNCIL OF AUSTRALIA METHOD OF MEASUREMENT FOR LETTABLE AREA (2008 REVISION)

**TENANCY AREA**  
 CASSELDEN PLACE  
 2 LONSDALE STREET MELBOURNE  
**LEVEL 2**

DATE OF SURVEY	VERSION	PROJECT No.  VW05233
21/10/2010	0	
DRAWN	CHECKED	
MAO	STEPHEN FALZON (LS)	