

CASSELDEN PLACE

TENANCIES

LEVEL 27

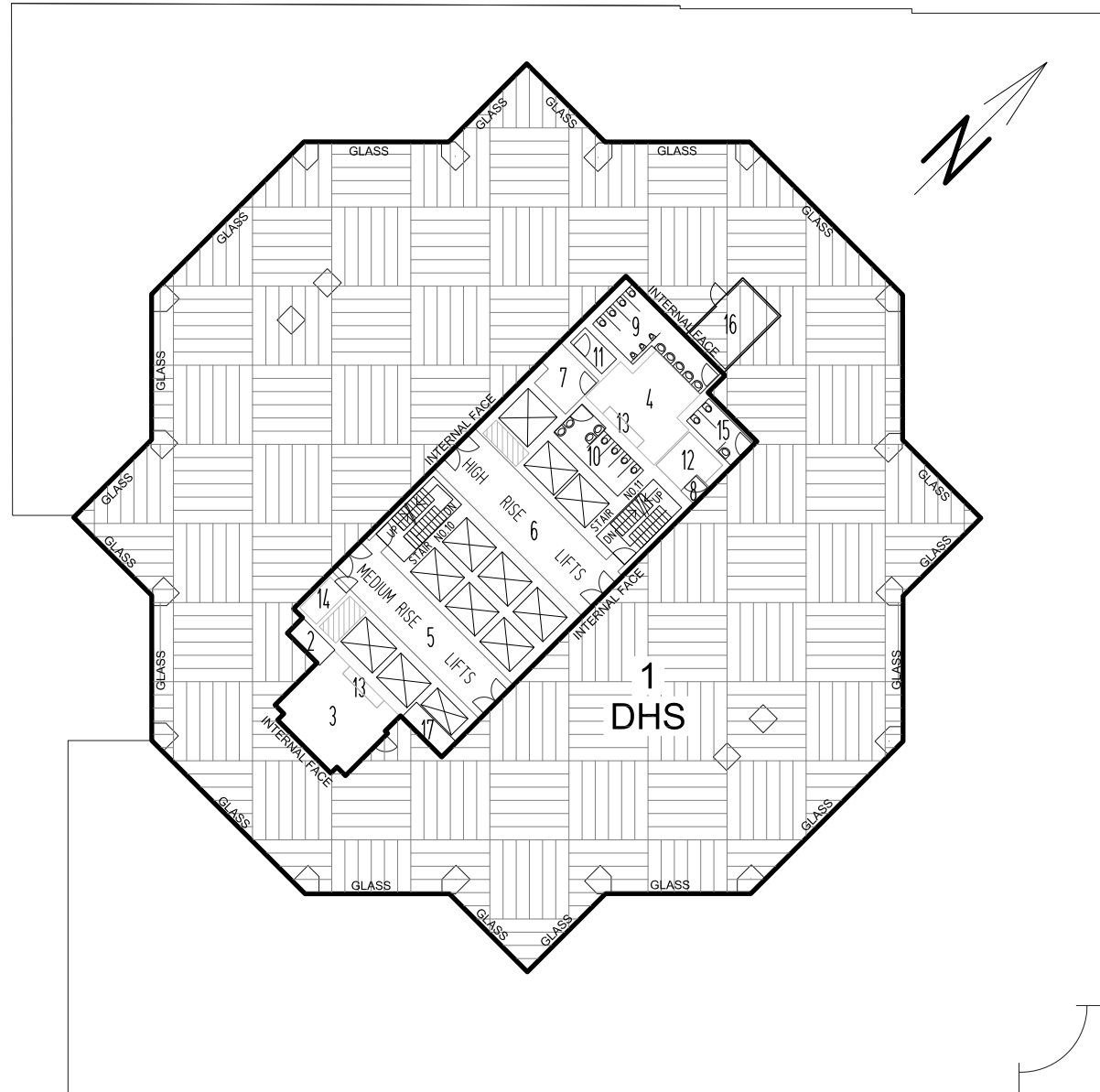

LONSDALE STREET

STREET

SPRING

1 DHS - NLA 1457.3m²

WHOLE FLOOR NLA 1457.3m²
TENANCY NLA 1457.3m²

2 FORMER COMMS (Removed)	3.3m ²	10 FEMALE TOILET:	11.5m ²
3 AHU (24.9m ² inside)	28.6m ²	11 CLEANERS ROOM:	2.5m ²
4 AHU (20.8m ² inside)	24.5m ²	12 TEA ROOM:	6.8m ²
5 LIFT LOBBY:	34.2m ²	13 MECH. PIPE RISERS	4.2m ²
6 LIFT LOBBY:	40.3m ²	14 ELEC, TELE ROOM:	3.2m ²
7 GOODS LIFT LOBBY:	7.9m ²	15 FEMALE TOILET:	6.6m ²
8 LOBBY:	1.1m ²	16 COMMS	14.6m ²
9 MALE TOILET:	17.8m ²	17 DISUSED COMMS	4.0m ²

RISERS	5.5m ²	STAIR No. 10:	10.7m ²
SHAFTS	85m ²	STAIR No. 11:	10.7m ²

NOTE:

THE NET LETTABLE AREA IS SHOWN ENCLOSED BY CONTINUOUS THICK LINES.

THE NET LETTABLE AREA IS BASED ON THE PROPERTY COUNCIL OF AUSTRALIA METHOD OF MEASUREMENT FOR LETTABLE AREA (2008 REVISION)

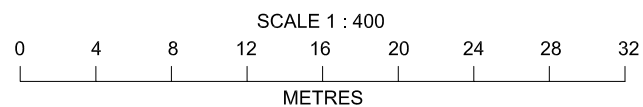

TENANCY AREA
CASSELDEN PLACE
2 LONSDALE STREET MELBOURNE
LEVEL 27

DATE OF SURVEY	VERSION	PROJECT No.
20/10/2010	0	
DRAWN	CHECKED	VW05233
MAO	STEPHEN FALZON (LS)	