

# CASSELDEN PLACE

TENANCIES

-

LEVEL 3

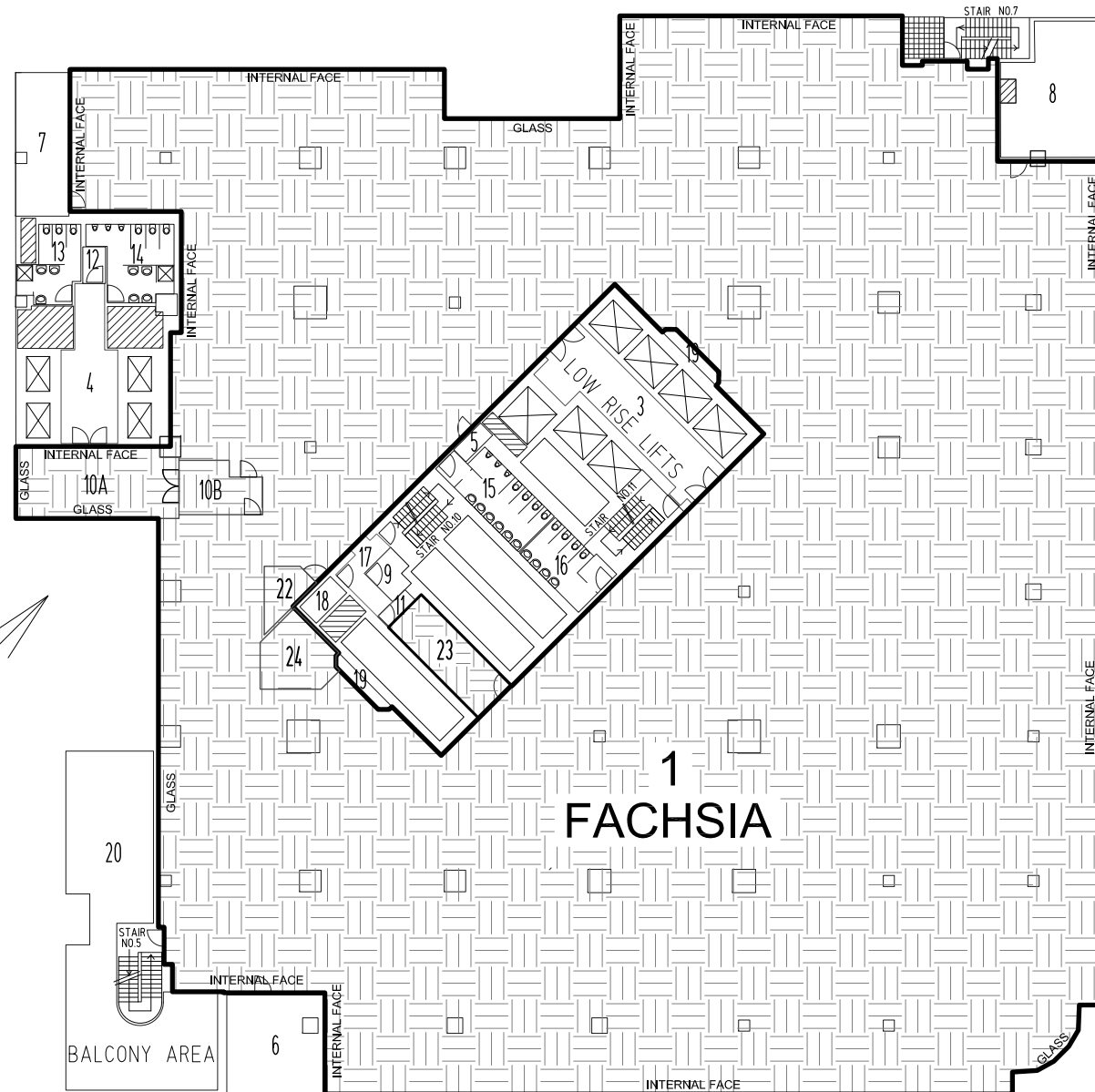

**1 FACHSIA NLA - 2925.8m<sup>2</sup>**  
 (Includes Store room 23)  
 (For lease purposes NLA 2,920.1m<sup>2</sup>)

**WHOLE FLOOR NLA 2925.8m<sup>2</sup>**  
**TENANCY NLA 2925.8m<sup>2</sup>**

3	LIFT LOBBY:	37.8m <sup>2</sup>	14	MALE TOILETS:	17.6m <sup>2</sup>
4	PODIUM LIFT LOBBY:	24.6m <sup>2</sup>	15	MALE TOILETS:	18.4m <sup>2</sup>
5	SVR	2.1m <sup>2</sup>	16	FEMALE TOILETS:	14.5m <sup>2</sup>
6	AHU	32.6m <sup>2</sup>	17	PASSAGE	7.1m <sup>2</sup>
7	AHU	23.2m <sup>2</sup>	18	ELEC, TELE ROOM:	3.2m <sup>2</sup>
8	AHU	41.9m <sup>2</sup>	19	MECH. PIPE RISERS	5.6m <sup>2</sup>
9	TEA ROOM:	4.5m <sup>2</sup>	20	BALCONY AREA	104.2m <sup>2</sup>
10A	COMMON AREA	39.2m <sup>2</sup>	(NOT INCLUDING STAIRS)		
10B	COMMON AREA	13.2m <sup>2</sup>	22	COMMS	7.0m <sup>2</sup>
11	CLEANERS ROOM:	2.0m <sup>2</sup>	23	STORAGE	20.1m <sup>2</sup>
12	CLEANERS ROOM	2.0m <sup>2</sup>	24	COMMS	15.5m <sup>2</sup>
13	FEMALE TOILETS:	11.9m <sup>2</sup>			

	RISERS	25.5m <sup>2</sup>
	SHAFTS	74m <sup>2</sup>
	EXHAUSTS	5.8m <sup>2</sup>

STAIR No. 5: 14.7m<sup>2</sup> STAIR No. 7: 11.1m<sup>2</sup>  
 STAIR No. 10: 10.9m<sup>2</sup> STAIR No. 11: 10.9m<sup>2</sup>

STREET  
 SPRING

LONSDALE STREET

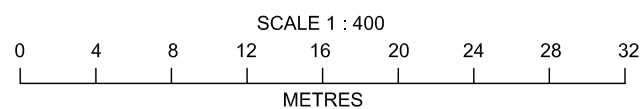

**NOTE:**

THE NET LETTABLE AREA IS SHOWN ENCLOSED BY CONTINUOUS THICK LINES.

THE NET LETTABLE AREA IS BASED ON THE PROPERTY COUNCIL OF AUSTRALIA METHOD OF MEASUREMENT FOR LETTABLE AREA (2008 REVISION)

**TENANCY AREA**  
**CASSELDEN PLACE**  
**2 LONSDALE STREET MELBOURNE**  
**LEVEL 3**

DATE OF SURVEY	VERSION	PROJECT No.  VW05233
15/11/2010	0	
DRAWN	CHECKED	
MAO	STEPHEN FALZON (LS)	