

# CASSELDEN PLACE

TENANCIES

LEVEL 4

1 ATO office - NLA 1260.0m<sup>2</sup>  
(For lease purposes NLA 1,267.3m<sup>2</sup>)  
ATO storage area 22 - 20.1m<sup>2</sup>

30 DIAC - NLA 282.6m<sup>2</sup>  
(For lease purposes NLA 288.6m<sup>2</sup>)

32 DIAC - NLA 763.8m<sup>2</sup>  
(For lease purposes NLA 768.6m<sup>2</sup>)

34 Superpartners - NLA 387.0m<sup>2</sup>

WHOLE FLOOR AREA NLA 2886.8m<sup>2</sup>  
TENANCY NLA 2713.5m<sup>2</sup>

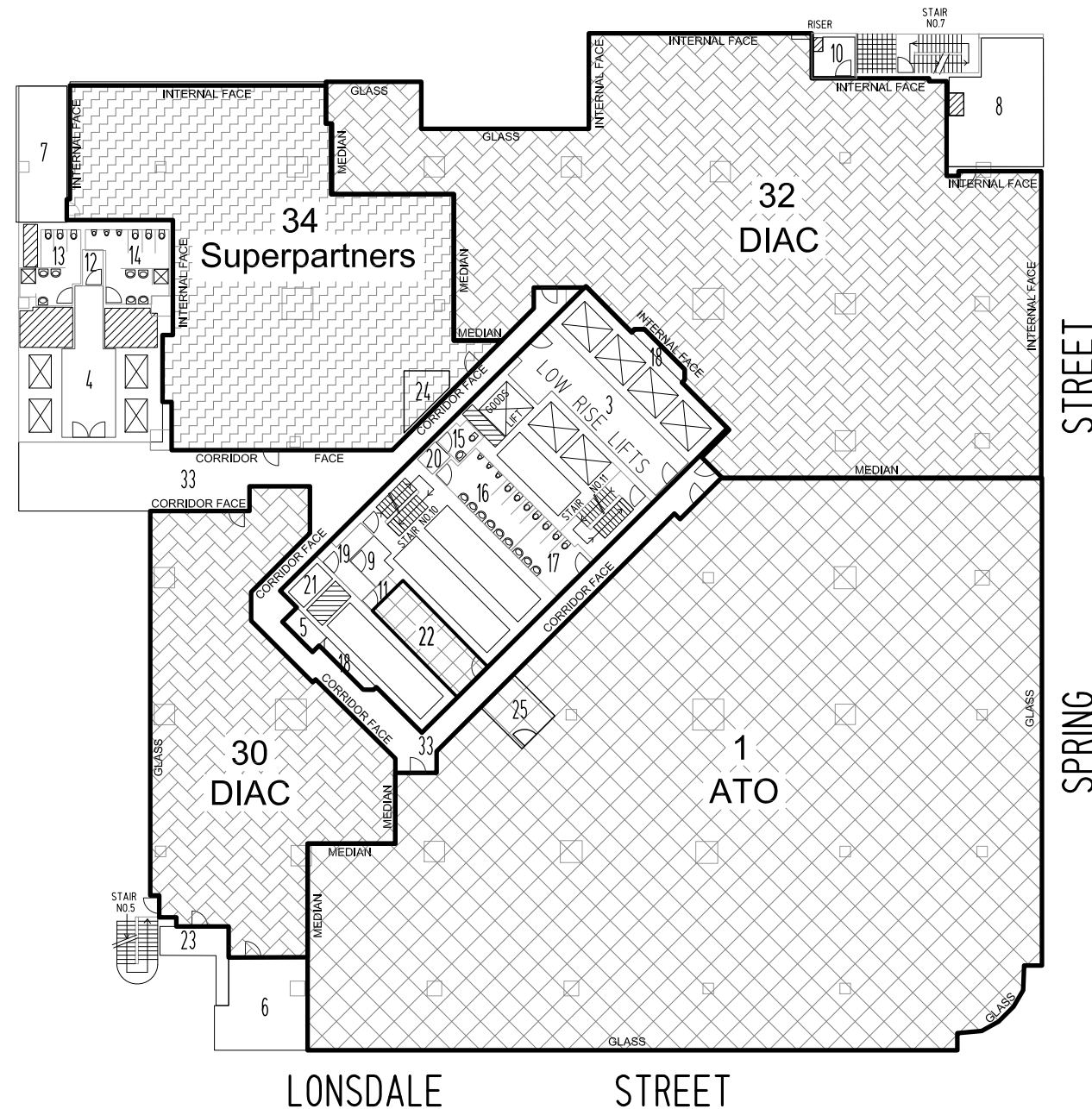

3	LIFT LOBBY:	37.3m <sup>2</sup>
4	LIFT LOBBY:	24.6m <sup>2</sup>
5	DISUSED COMMS:	3.3m <sup>2</sup>
6	AHU	30.3m <sup>2</sup>
7	AHU	23.2m <sup>2</sup>
8	AHU	41.9m <sup>2</sup>
9	TEA ROOM:	4.5m <sup>2</sup>
10	TEA ROOM:	5.7m <sup>2</sup>
11	CLEANERS ROOM:	2.0m <sup>2</sup>
12	CLEANERS ROOM:	2.8m <sup>2</sup>
13	FEMALE TOILETS:	11.9m <sup>2</sup>
14	MALE TOILETS:	17.6m <sup>2</sup>

15	UNISEX DISABLED:	4.0m <sup>2</sup>
16	MALE TOILETS:	18.5m <sup>2</sup>
17	FEMALE TOILETS:	11.6m <sup>2</sup>
18	MECH. PIPE RISERS	5.6m <sup>2</sup>
19	PASSAGE:	7.1m <sup>2</sup>
20	PASSAGE:	2.0m <sup>2</sup>
21	ELEC, TELE ROOM:	3.2m <sup>2</sup>
22	STORAGE AREA	20.1m <sup>2</sup>
23	PRESSURISATION ROOM & DUCT	9.8m <sup>2</sup>
24	COMMS	6.7m <sup>2</sup>
25	COMMS	10.0m <sup>2</sup>
33	PASSAGE	173.3m <sup>2</sup>

	RISERS	25.5m <sup>2</sup>
	SHAFTS	74m <sup>2</sup>
	EXHAUSTS	5.8m <sup>2</sup>

STAIR No. 5: 14.7m<sup>2</sup> STAIR No. 7: 11.1m<sup>2</sup>  
STAIR No. 10: 10.9m<sup>2</sup> STAIR No. 11: 10.9m<sup>2</sup>

**NOTE:**

THE NET LETTABLE AREA IS SHOWN ENCLOSED BY CONTINUOUS THICK LINES.

THE NET LETTABLE AREA IS BASED ON THE PROPERTY COUNCIL OF AUSTRALIA METHOD OF MEASUREMENT FOR LETTABLE AREA (2008 REVISION)

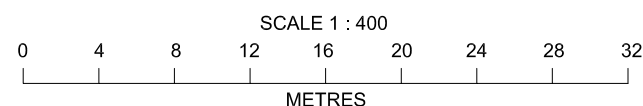

## TENANCY AREA

CASSELDEN PLACE  
2 LONSDALE STREET MELBOURNE  
LEVEL 4

DATE OF SURVEY	VERSION	PROJECT No.  VW05233
19/10/2010	0	
DRAWN	CHECKED	
MAO	STEPHEN FALZON (LS)	