

**NOTES:**

- 1. AREAS IDENTIFIED THERE-IN ARE PROPOSED AND THEREFORE SUBJECT TO FINAL SURVEY.

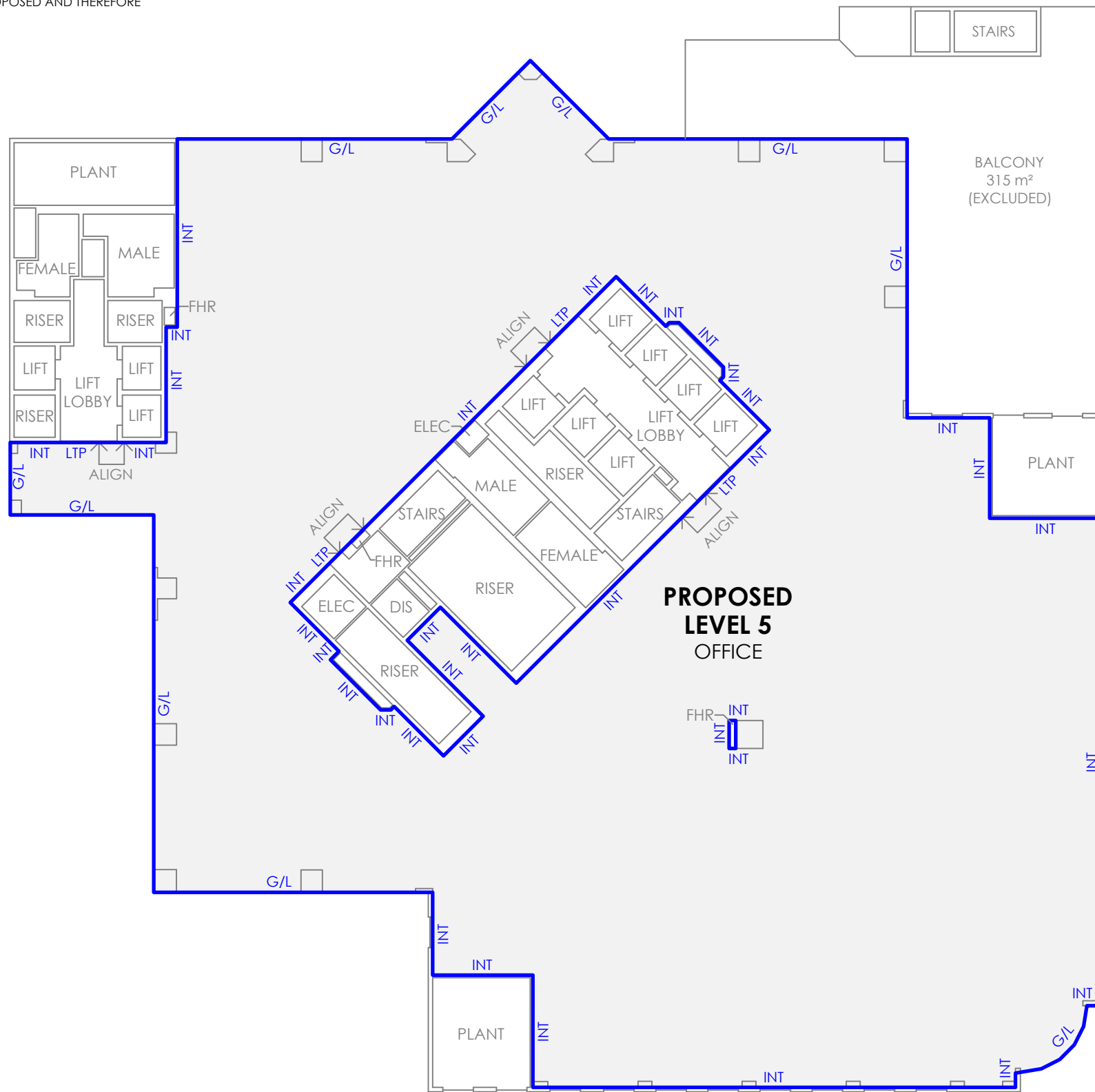

MADAME BRUSSELS LANE



**PROPOSED  
LEVEL 5  
OFFICE**

BALCONY  
315 m<sup>2</sup>  
(EXCLUDED)

**SCHEDULE OF AREAS**

LEVEL 5 OFFICE	2,250.9 m <sup>2</sup>
-------------------	------------------------

LETTABLE AREA



THE LETTABLE AREA IS SHOWN ENCLOSED BY CONTINUOUS LINES

**METHOD OF MEASUREMENT**

AREAS HAVE BEEN CALCULATED IN ACCORDANCE AND UNDER INTERPRETATION OF THE PROPERTY COUNCIL OF AUSTRALIA (PCA) METHOD OF MEASUREMENT FOR LETTABLE AREA (2008)

(NOT SURVEYED)

**GUIDELINES USED  
NET LETTABLE AREA**

ALL PARTIES USING THE AREAS EXPRESSED HEREIN, SHOULD AGREE WITH THE BOUNDARY DEFINITIONS, THIS PLAN WAS PRODUCED FOR THE CALCULATION OF FLOOR AREAS ONLY

**LEGEND**

- INT - INTERNAL FACE
- G/L - GLASS LINE
- LTP - LINE OF TENANCY PRODUCED

LONSDALE STREET

SPRING STREET



CLIENT:

**CBRE**

**PROPOSED LETTABLE AREA PLAN**  
LEVEL 5, 2 LONSDALE STREET,  
MELBOURNE, VIC

DATE: 28/08/2024 REV: 1  
REF: 90435 DRAWN: JEH  
SURVEYED: -- CHECKED: IN  
SCALE: 1:300 @ A3 SHEET: 1 OF 1

Australia | New Zealand

**REALSERVE**  
Start confident.

Building Measurement Specialist  
Consulting Land Surveyors  
3D Laser Scanning  
**ph. 03 9415 6565**  
www.realserve.com.au