

# CASSELDEN PLACE

TENANCIES

LEVEL 6

- 1 DIAC office - NLA 1001.3m<sup>2</sup>  
(For lease purposes NLA 972.9m<sup>2</sup>)
- 2 Superpartners office - NLA 1183.4m<sup>2</sup>  
(For lease purposes NLA 1,162.6m<sup>2</sup>)  
Superpartners storage area 15 - 20.1m<sup>2</sup>

WHOLE FLOOR NLA 2271.4m<sup>2</sup>  
TENANCY NLA 2204.8m<sup>2</sup>

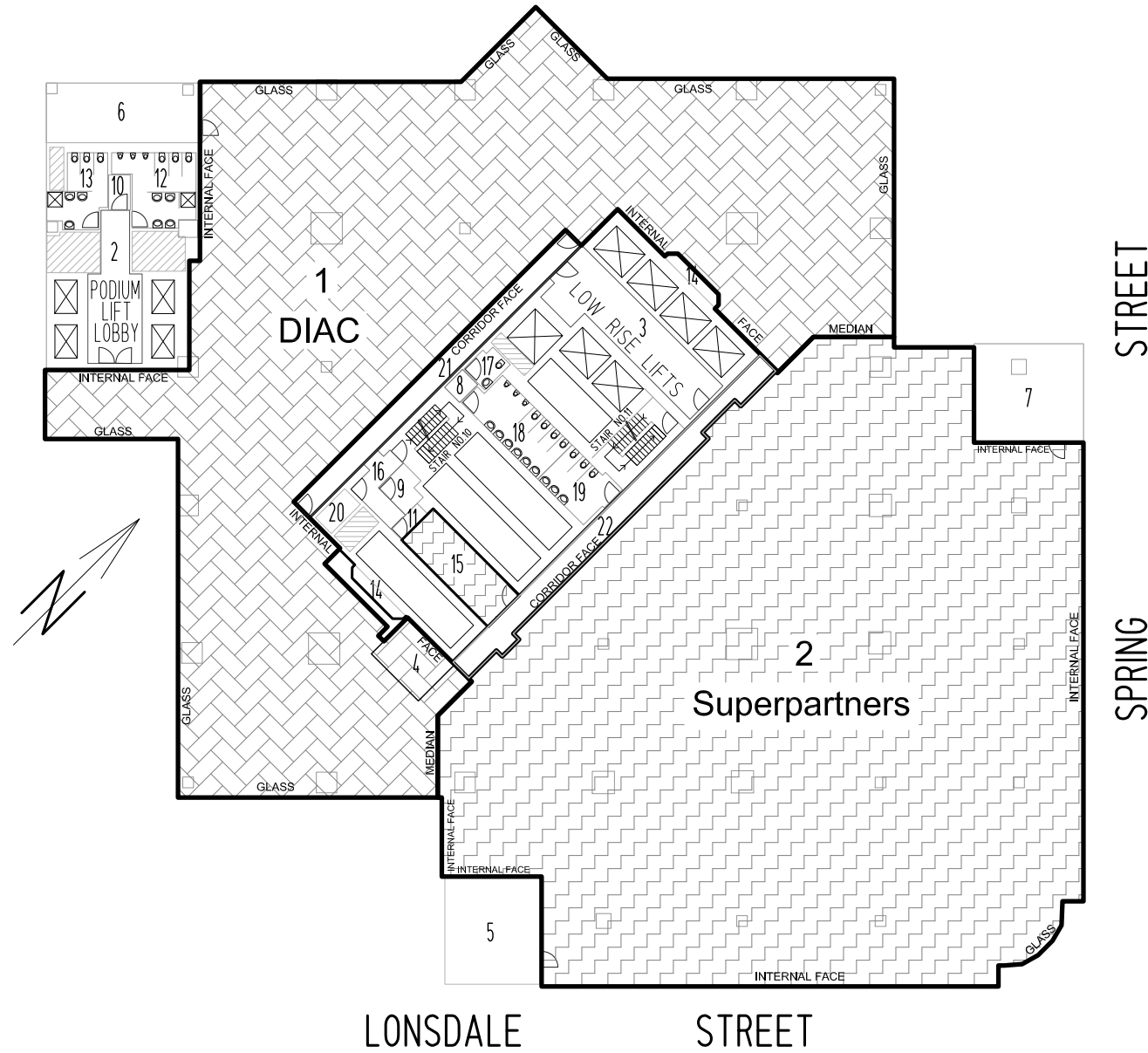

2 LIFT LOBBY:	24.6m <sup>2</sup>	9 TEA ROOM:	4.5m <sup>2</sup>	16 PASSAGE:	7.1m <sup>2</sup>
3 LIFT LOBBY:	37.3m <sup>2</sup>	10 CLEANERS ROOM:	2.0m <sup>2</sup>	17 UNISEX DISABLED:	4.0m <sup>2</sup>
4 COMMS	12.6m <sup>2</sup>	11 CLEANERS ROOM:	2.0m <sup>2</sup>	18 MALE TOILETS:	18.5m <sup>2</sup>
5 AHU :	12.1m <sup>2</sup>	12 MALE TOILETS:	17.6m <sup>2</sup>	19 FEMALE TOILETS:	11.6m <sup>2</sup>
6 AHU :	34.3m <sup>2</sup>	13 FEMALE TOILETS:	11.9m <sup>2</sup>	20 ELEC, TELE ROOM	3.2m <sup>2</sup>
7 AHU :	37.6m <sup>2</sup>	14 MECH. PIPE RISERS:	5.6m <sup>2</sup>	21 PASSAGE	31.5m <sup>2</sup>
8 PASSAGE:	2.0m <sup>2</sup>	15 STORAGE AREA	20.1m <sup>2</sup>	22 PASSAGE	35.1m <sup>2</sup>

RISERS	24.2m <sup>2</sup>
SHAFTS	74m <sup>2</sup>

STAIR No. 10:	10.9m <sup>2</sup>
STAIR No. 11:	10.9m <sup>2</sup>

### NOTE:

THE NET LETTABLE AREA IS SHOWN ENCLOSED BY CONTINUOUS THICK LINES.

THE NET LETTABLE AREA IS BASED ON THE PROPERTY COUNCIL OF AUSTRALIA METHOD OF MEASUREMENT FOR LETTABLE AREA (2008 REVISION)

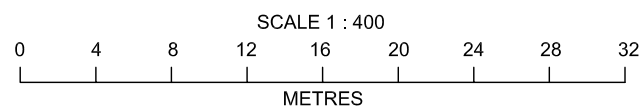

## TENANCY AREA

### CASSELDEN PLACE

### 2 LONSDALE STREET MELBOURNE

## LEVEL 6

DATE OF SURVEY	VERSION	PROJECT No.
15/11/2010	0	
DRAWN	CHECKED	VW05233
MAO	STEPHEN FALZON (LS)	