

CASSELDEN PLACE TENANCIES LEVEL 8

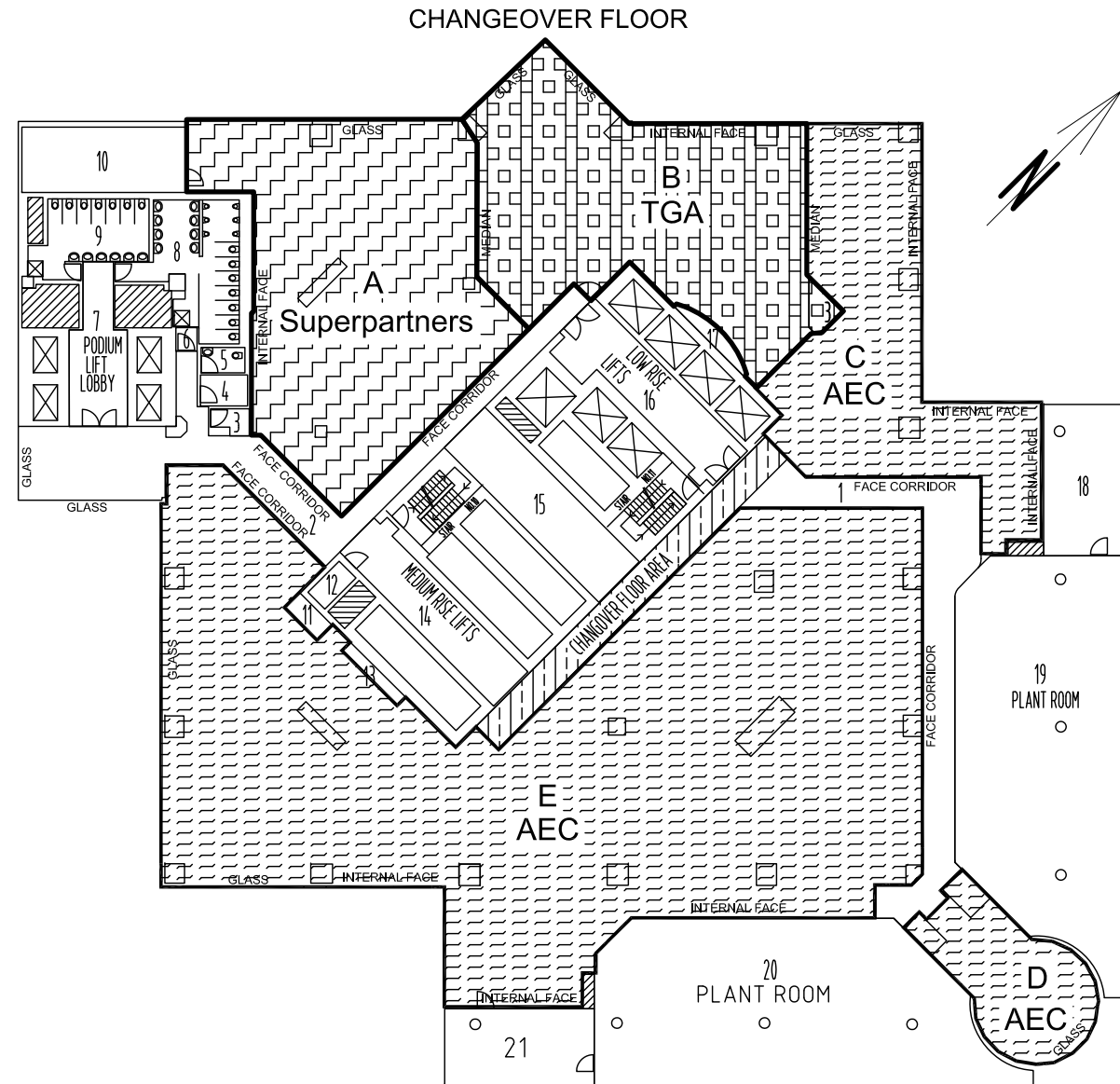

A Superpartners - NLA 269.3m²
 B TGA - NLA 234.8m²
 (For lease purposes NLA 232.0m²)

C AEC - NLA 181.4m²
 D AEC - NLA 61.6m²
 E AEC - NLA 815.1m² } Total AEC = 1058.1m²

WHOLE FLOOR NLA 1777.8m²
 TENANCY NLA 1562.2m²

LIFT CORE: 326.1m²

ALLOW 40.0m² OF PASSAGE 1 FOR CHANGEOVER FLOOR

1	PASSAGE	119.6m ²	12	ELEC, TELE ROOM	3.2m ²
2	PASSAGE	96.0m ²	13	MECH. PIPE RISERS	3.0m ²
3	SVR	2.8m ²	14	LIFT LOBBY:	34.9m ²
4	TEA ROOM	4.7m ²	15	LOBBY:	40.3m ²
5	UNISEX DISABLED	3.6m ²	16	LIFT LOBBY:	37.8m ²
6	CLEANERS ROOM	1.6m ²	17	MECH PIPE RISERS	4.0m ²
7	PODIUM LIFT LOBBY:	25.0m ²	18	AHU	38.5m ²
8	MALE TOILETS:	35.6m ²	19	PLANT ROOM	198.2m ²
9	FEMALE TOILETS	24.4m ²	20	PLANT ROOM	198.2m ²
10	AHU	34.5m ²	21	AHU	38.5m ²
11	COMM. CUPBOARD:	3.1m ²			

	RISERS	23.9m ²	STAIR No. 10:	10.9m ²
	SHAFTS	74m ²	STAIR No. 11:	10.9m ²

NOTE:

THE NET LETTABLE AREA IS SHOWN ENCLOSED BY CONTINUOUS THICK LINES.

THE NET LETTABLE AREA IS BASED ON THE PROPERTY COUNCIL OF AUSTRALIA METHOD OF MEASUREMENT FOR LETTABLE AREA (2008 REVISION)

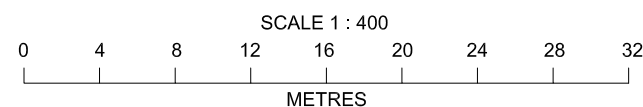

TENANCY AREA CASSELDEN PLACE 2 LONSDALE STREET MELBOURNE LEVEL 8

DATE OF SURVEY	VERSION	PROJECT No.
3/11/2010	1	VW05233
DRAWN	CHECKED	
MAO	STEPHEN FALZON (LS)	